



2025 Traverwood

Ann Arbor, MI

2025 Traverwood is located off Plymouth Road in northeast Ann Arbor, directly across from University of Michigan's North Campus and just minutes from downtown Ann Arbor, US-23, and an easy commute from metro Detroit.

Contact us for a tour and additional information. (734) 994-5050
firstmartin@firstmartin.com

Features

- Operable Windows
- Ample Parking
- Monument Sign
- Well Capitalized Owner

Space Available

- Up to 10,771 SF

Zoned

- Office
- Medical/Dental

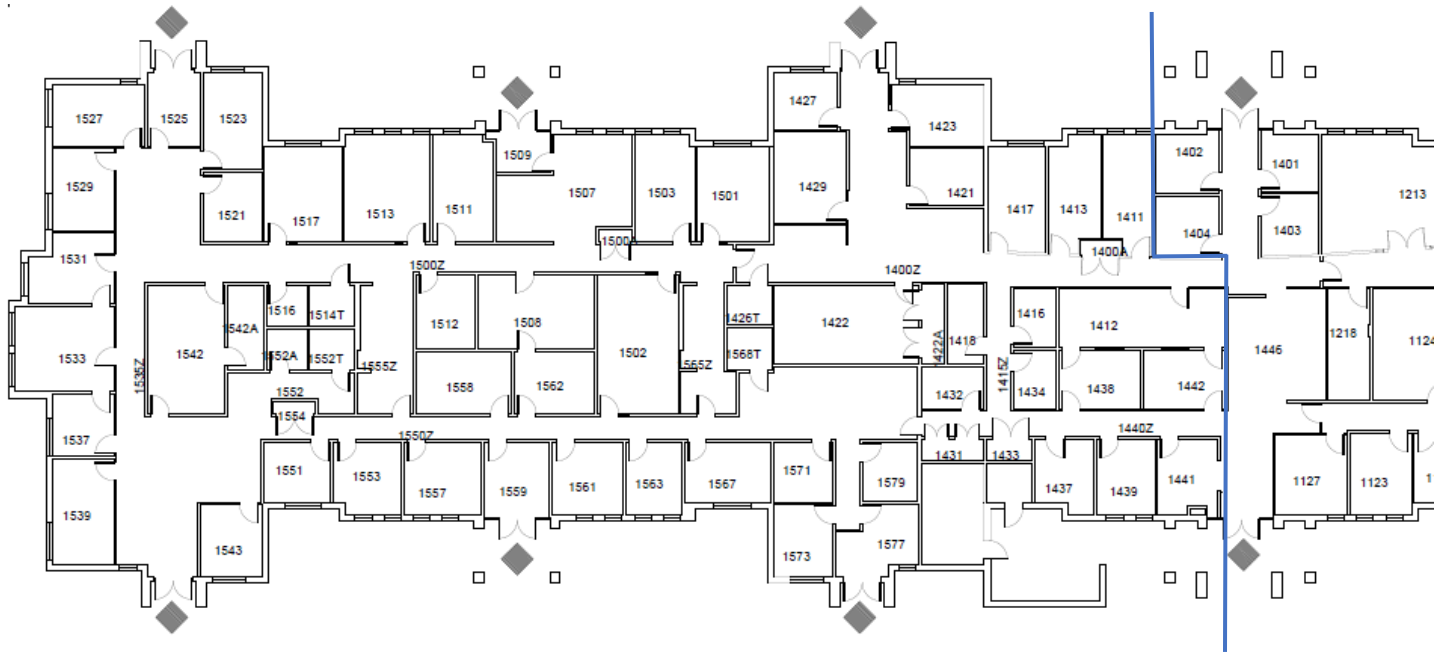

**2025 Traverwood Drive
Up to 10,771 SF**

WE ARE
HERE.

First Martin is a full-service commercial real estate firm with an approach focusing on both the big picture and the small details, helping Ann Arbor remain vibrant. We invest in our relationships, balancing a decades-long view of real estate development with service in minutes.

Get in touch today to explore our portfolio of available commercial properties. Visit us at firstmartin.com to view all properties.