



2025 Traverwood

Ann Arbor, MI

2025 Traverwood is located off Plymouth Road in northeast Ann Arbor, directly across from University of Michigan's North Campus and just minutes from downtown Ann Arbor, US-23, and an easy commute from metro Detroit.

Features

- Operable Windows
- Ample Parking
- Monument Sign

Space Available

- Up to 13,153 SF
- Now Available

Contact us for a tour and additional information. (734) 994-5050
firstmartin@firstmartin.com

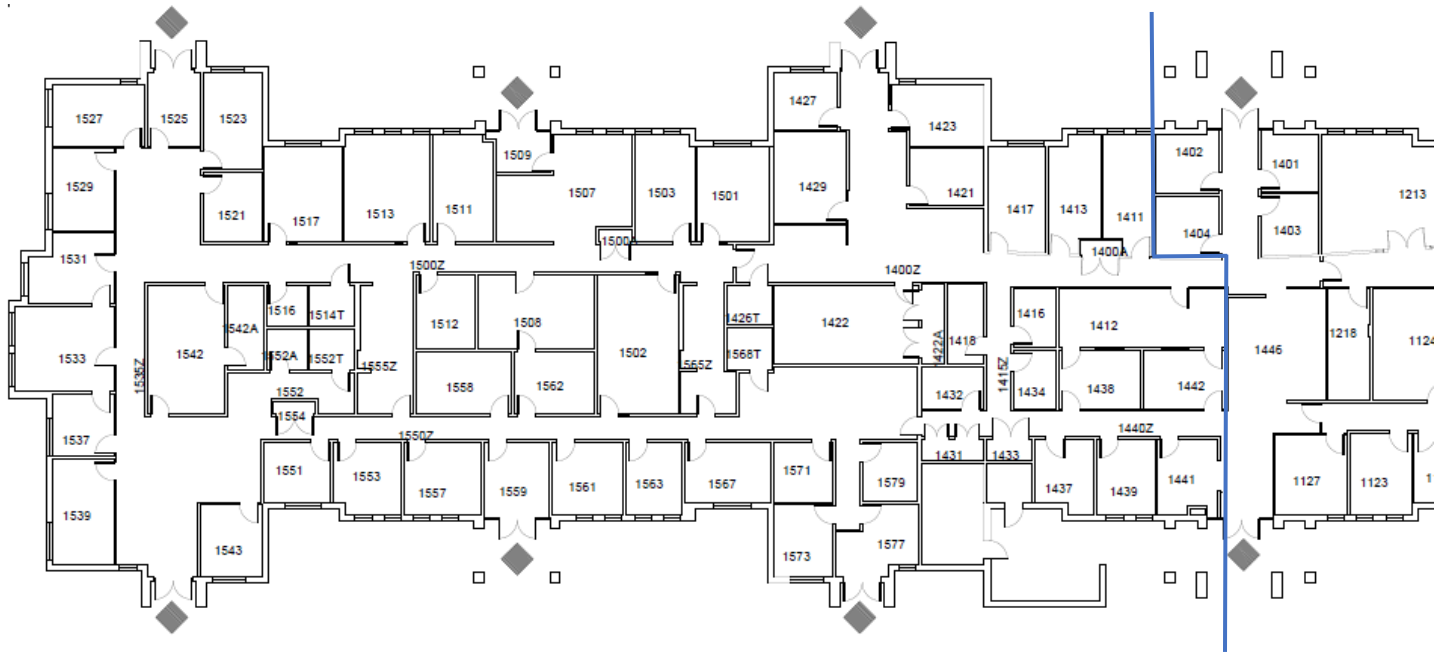

**2025 Traverwood Drive
Up to 13,153 SF**

WE ARE
HERE.

First Martin is a full-service commercial real estate firm with an approach focusing on both the big picture and the small details, helping Ann Arbor remain vibrant. We invest in our relationships, balancing a decades-long view of real estate development with service in minutes.

Get in touch today to explore our portfolio of available commercial properties. Visit us at firstmartin.com to view all properties.