



2001 Commonwealth

Suite 300-301, Ann Arbor, MI

2001 Commonwealth Boulevard is a three-story brick office facility with a full glass atrium entrance. The building's contemporary architecture and lush landscaping provide modern executive offices in Plymouth Park, the heart of Ann Arbor's research corridor.

Plymouth Park is located off Plymouth Road in northeast Ann Arbor, ½ mile from US-32 and an easy commute from metro Detroit. Over 325,000 SF in eight buildings make up the Park.

Features

- Operable Windows
- Ample Parking

Space Available

Suite 300-301

USF: 3,594

RSF: 4,107

Suite can be divided

Contact us for a tour and additional information. (734) 994-5050
firstmartin@firstmartin.com

Suite 300
USF: 1,013
RSF: 1,165

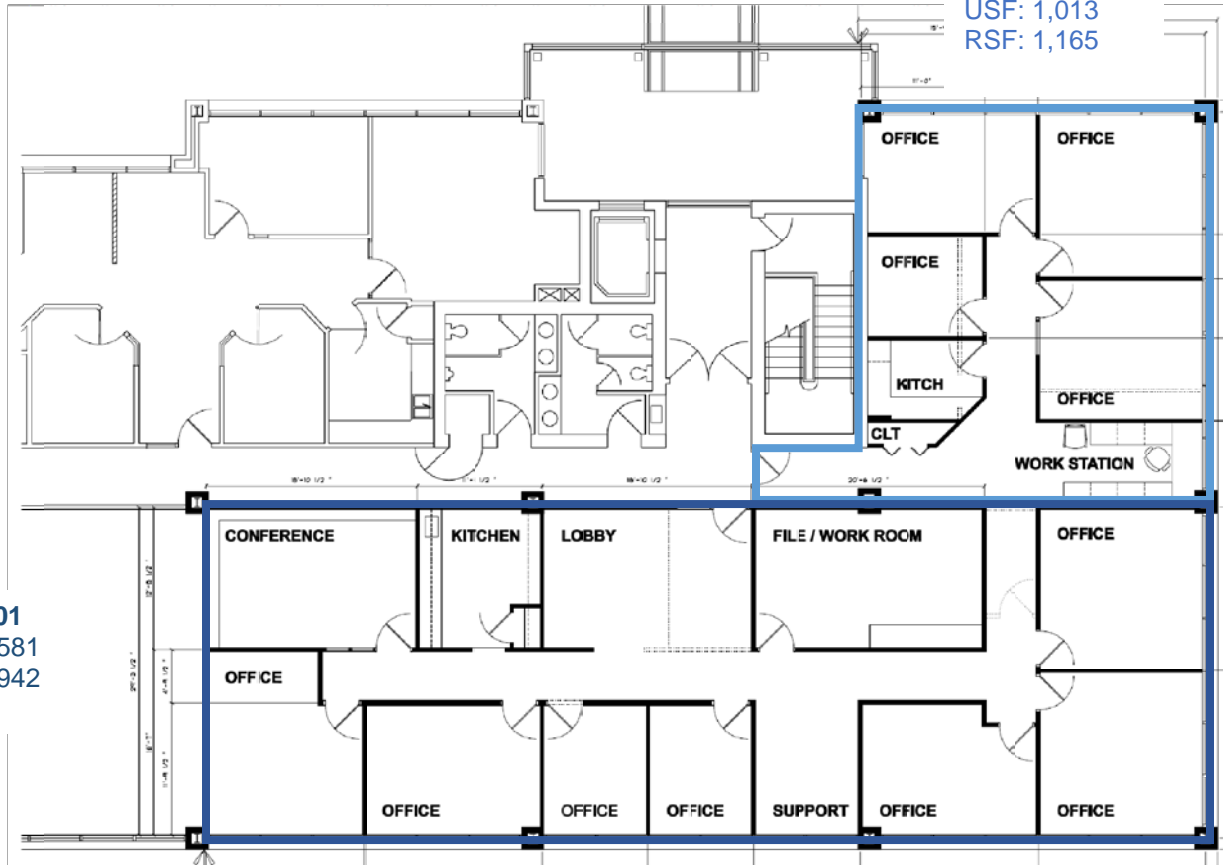

Suite 301
USF: 2,581
RSF: 2,942

Combined Suite 300-301
USF: 3,597
RSF: 4,107

2001 Commonwealth, Suite 300-301

WE ARE
HERE.

First Martin is a full-service commercial real estate firm with an approach focusing on both the big picture and the small details, helping Ann Arbor remain vibrant. We invest in our relationships, balancing a decades-long view of real estate development with service in minutes.

Get in touch today to explore our portfolio of available commercial properties. Visit us at firstmartin.com to view all properties.